



## 涂鸦蓝牙智能筒射灯电源高端系列

- 无线调光和色温可调 / Wireless dimmable and cct tunable
- 无需安装控制线和其他控制器 / No need install control wire and other controllers
- 两路输出，共阳极 / Two channels output, common anode
- 输出恒流驱动器 / Output constant current driver
- 宽输出电压范围，电流可调 / Wide output voltage range and adjustable current
- 5年质保 /5-years warranty
- 涂鸦平台，蓝牙 mesh 协议/Tuya platform, Bluetooth mesh

## 功能/Functions

- 通过蓝牙无线控制调光和色温调节 /Through Bluetooth wireless control dimming and color temperature adjustment
- 场景模式控制 /Scene mode control
- 短路保护 /Short-circuit protection
- 空载保护 /No-load protection
- 浪涌电压 1KV /Surge protection voltage 1KV
- 高 PF 无频闪 /High PF no strobe



## 尺寸/Dimension

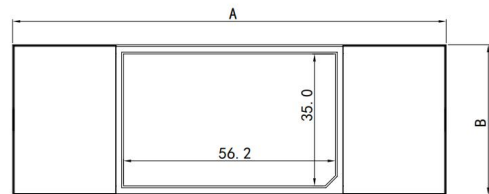
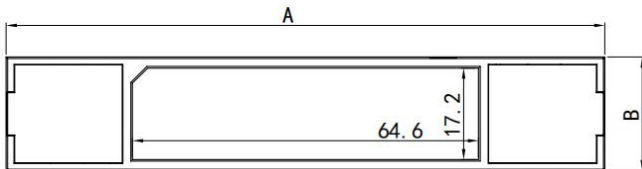
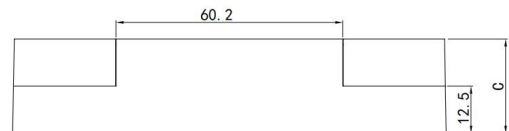

A\*B\*C= 111.5 \*21.5 \* 20 mm (适合 30mm 开孔)

A\*B\*C= 115 \*40 \* 25 mm (适合 50mm 开孔)

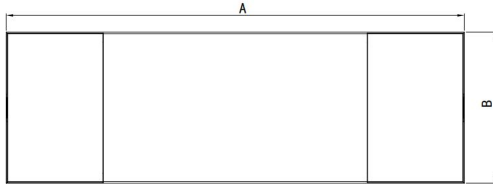
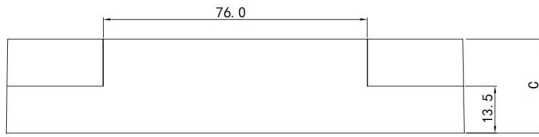

A\*B\*C= 132.5 \*44 \* 27 mm (适合 55mm 开孔)

## 技术数据/Technical Date

### For Driver

型号	DN-TYLxx-02
额定输入电压	AC100-240V
最大输入电流	0.45A
电源频率	50/60Hz
输出电压	25-41VDC
输出电流	65-1050mA
调光范围	1%-100%
效率	>80%
功率因数	0.9 PF
寿命	30,000Hour
使用温度	-20°C...+45°C
储存温度	-20°C...+80°C
尺寸	L112×W21.5×H20mm (适合 30mm 开孔)
	L115×W40×H25mm (适合 50mm 开孔)
	L132.5×W44×H27mm (适合 55mm 开孔)

### For RF-Bluetooth

可控距离	30 米 / 30Meters without Obstacle
协议	Bluetooth
工作频率	2.4GHz ISM band
接收灵敏度	-94.5dBm@1Mbps
发送功率	+10dBm
天线类型	PCB internal antenna
天线增益	1.0dBi
工作温度	-40°C...+105°C

### 产品标准/Standard

LVD	EN61347-2-13
LVD	EN61347-2-13
EMI	EN55015
RED	EN300 440
RED	EN301489-1/ EN301489-3
EMS	IEC6100-3-2/IEC6100-3-3
EMS	IEC6100-4-2/IEC6100-4-3/IEC6100-4-4
EMS	IEC6100-4-5/ IEC6100-4-6/IEC6100-4-8

## 安装接线/Installation and wiring

### 安装说明/Installation

安装前需考虑散热/Heat dissipation must be considered before installation.

不能安装于全金属包围的环境中，会导致金属屏蔽信号影响数据的接收。/It can not be installed in the environment surrounded by all metal, which will cause the metal shielding signal to affect the data reception.

使驱动器尽可能远离周围环境中的电磁干扰，以确保射频控制行为/Keep the drivers as far as possible away from electromagnetic interference in the surrounding environment to ensure RF controlling behavior.

安装时一定要切断电源/Make sure to keep mains off while installation.

建议 1: 所有的连接尽可能短，以确保良好的 EMC 性能。  
Suggestion 1: make all connection as short as possible to ensure good EMC behavior.

建议 2: 使用 0.75-1.5mm<sup>2</sup> 电线裸线长度 8-9mm /Suggestion 2: use 0.75-1.5mm<sup>2</sup> wire, strip length 8-9mm

### 接线图/Wiring Diagram

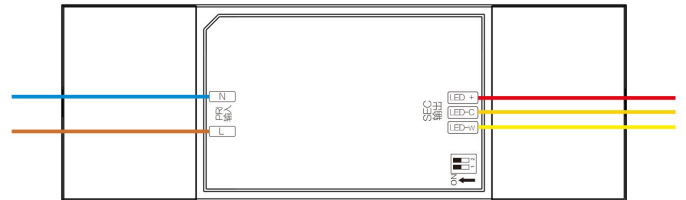

- 双路输出，共阳极 /Two channels output, common anode
- 输入 (L N) 接 100-240V 交流电源 / Input (L N) connected to 100-240V AC power supply
- C-用于冷白色 LED, W-用于暖色 LED /C- for cool white LED,W-for warm LED

## 所有的型号和规格/All models and specifications

型号 Model Number	输入电压 (V) Input Voltage	最大输入电流 (A) Max input Current	最大输入功率 (W) Max input Power	最大输出电压 (V) Max Output Voltage	最大输出电流 (mA) Max Output Current	功率因数 (PF) Power Factor	输出信道 Output channel	类型 Match colors
DN-TYL7W-02	100~240AC	0.07A	7W	25~42V	150mA	0.9	2	CW
DN-TYL15W-02	100~240AC	0.15A	15W	25~42V	350mA	0.9	2	CW
DN-TYL25W-02	100~240AC	0.25A	25W	25~41V	600mA	0.9	2	CW
DN-TYL45W-02	100~240AC	0.45A	45W	25~42V	1050mA	0.9	2	CW

### 电流输出选择/Output current selection

型号 Model Number	PIN1	PIN2	Output current (mA)
DN-TYL7W-02	OFF	OFF	65mA
	ON	OFF	110mA
	ON	ON	150mA
DN-TYL15W-02	OFF	OFF	150mA
	ON	OFF	210mA
	OFF	ON	280mA
	ON	ON	350mA
DN-TYL25W-02	OFF	OFF	350mA
	ON	OFF	410mA
	OFF	ON	500mA
	ON	ON	600mA
DN-TYL45W-02	OFF	OFF	720mA
	ON	OFF	850mA
	OFF	ON	950mA
	ON	ON	1050mA

## 应用/Application

适用于家居照明、室内办公照明、商业照明等智能应用场景

